



301 N. Hillcrest
Sulphur Springs, TX 75482

2000 I-30 E
Greenville, TX 75402

108 W. Marble
Wylie, TX 75098

Friday, January 10, 2020

Office of Hopkins County Judge
PO Box 288
Sulphur Springs TX 75483

Farmers Electric Cooperative Member: **KEN ORD**
Service Order Number: 1912001256

Greetings:

Farmers Electric Cooperative, Inc. is requesting permission to construct electrical power distribution facilities which will cross County Road 1127 which is located .7 miles south of CR 1120 in Hopkins County, Texas.

Site location map and construction sketches are enclosed. The construction sketch details the proposed work. All road crossings will have a minimum vertical clearance of 22 feet.

If you have any questions, please contact me at any time.

Sincerely,

Tamara Williams
Project Coordinator
twilliams@farmersselectric.coop
Phone 903-513-2903

Submitted by Brandon Darrow
bdarrow@farmersselectric.coop
Field Engineering Coordinator

Enclosures

County Approval Section:

Approved:

Denied:

Authorized Signature: *Brandon Darrow* Date: _____



2344043

P1 IS 0.7 MILES SOUTH OF CR 1120



Protective Device
is 25amp Fuse

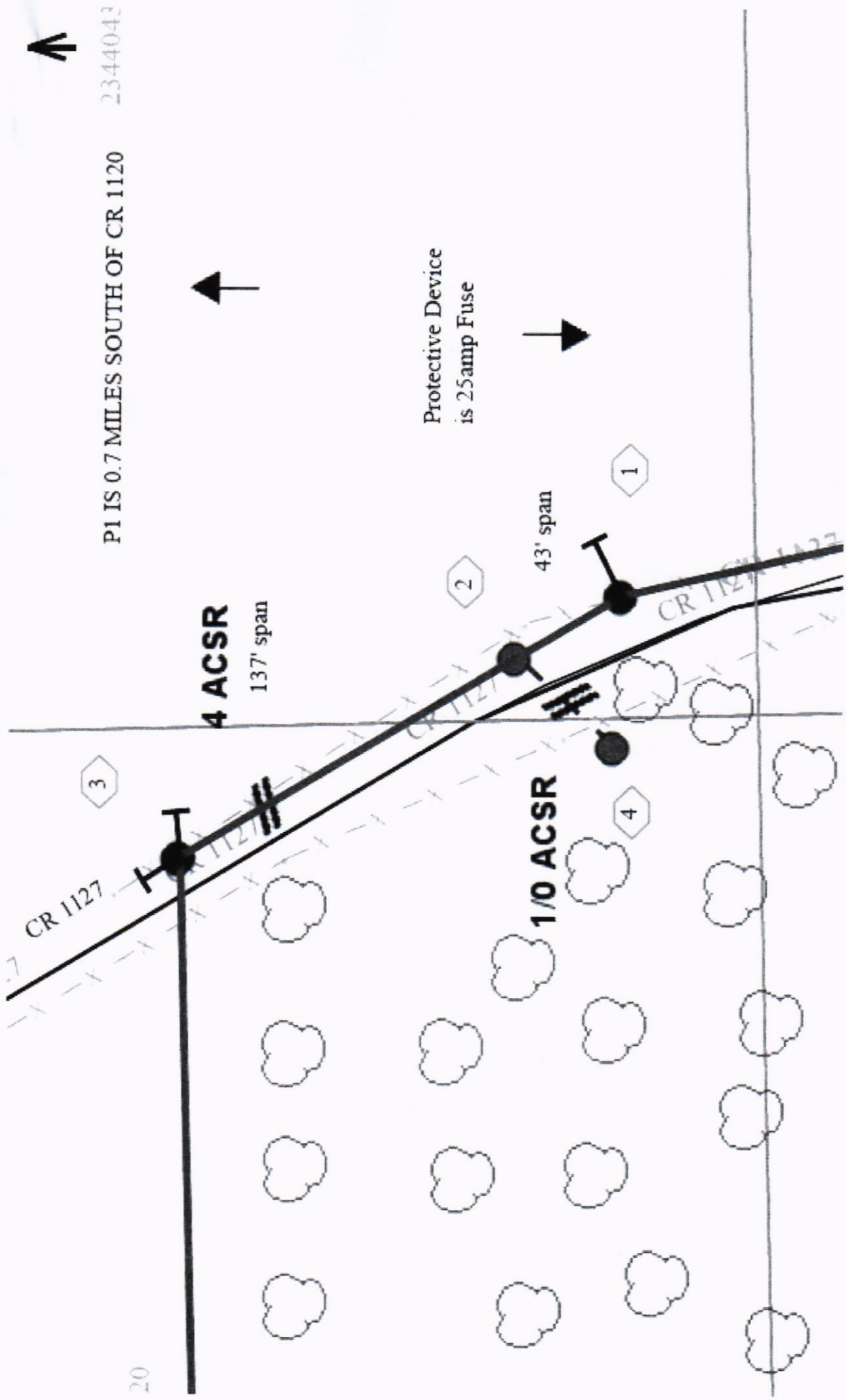

County Road 1127 N

0600080

0600079

County Road 1127 N

0600078

0600077

5750016

Ken Ord
Service Order#
1912001256

Set new pole north of
Pole#060078, cross
CR 1127, and set
another pole in line.

